

## Mounting instruction

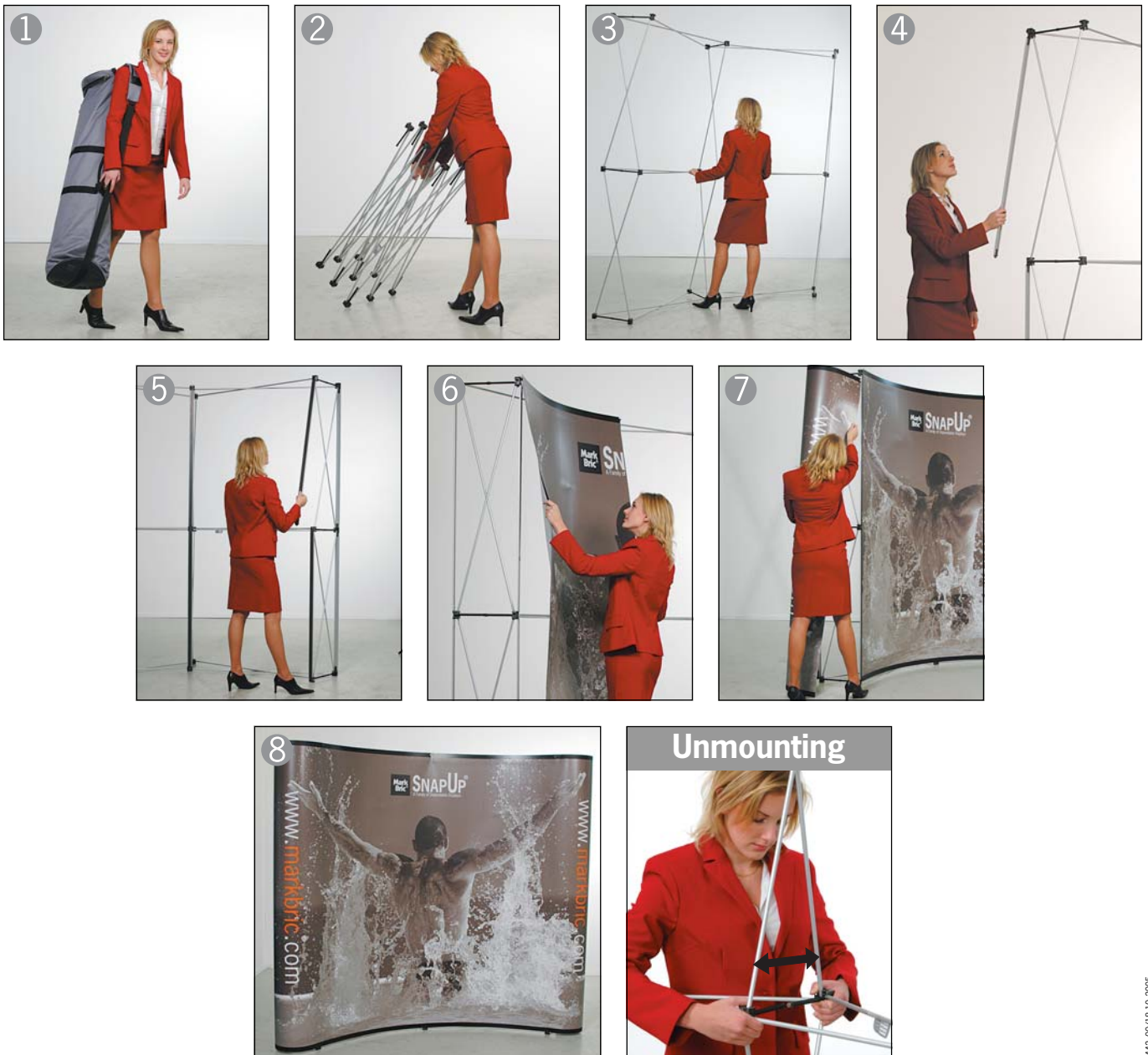

# Graphic panel production

## Size of graphic panels

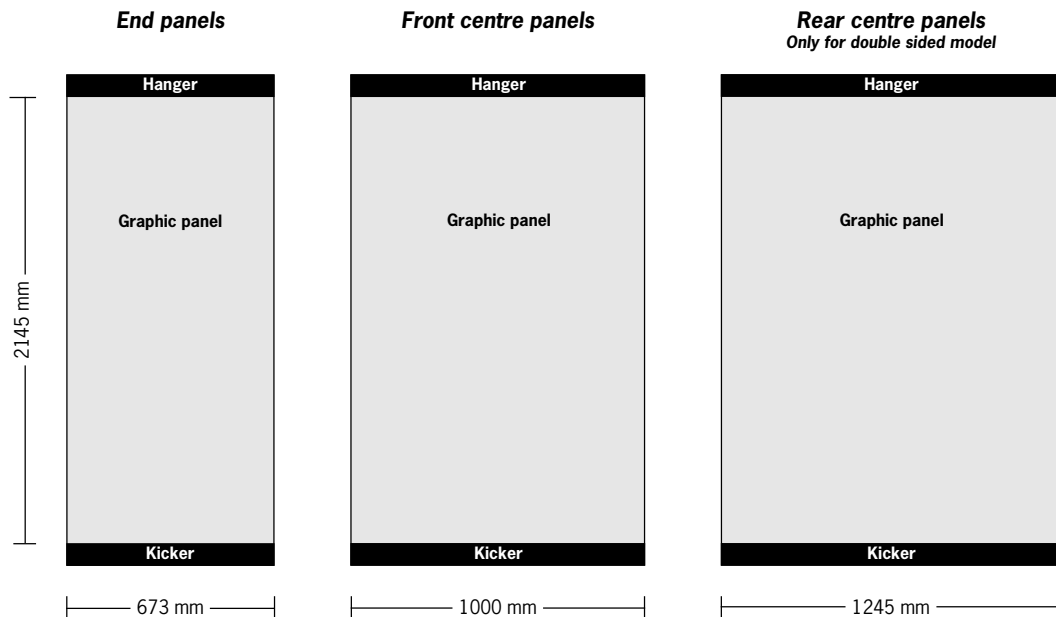

## Lamination

*The printed graphic panels must be laminated before use.*

*We recommended the following material:*

**Front side – Centre and end panels:**

150 microns (0,150 mm) "deep crystal"

**Reverse side – Centre panels:**

220-250 microns (0,220 - 0,250 mm) "stop light"

**Reverse side – End panels:**

115-125 microns (0,115 - 0,125 mm) "stop light"

**We recommend  
to roll the banner  
with the printed  
side out!**

## Application Techniques

To obtain optimum adhesion, the bonding surfaces must be well unified, clean and dry. Typical surface cleaning solvents are isopropyl alcohol/water mixture (rubbing alcohol) or heptane.

**Note:** Be sure to follow solvent manufacturer's precautions and directions for use when using solvents.

## Mounting of Kickers and Hangers

Kickers and hangers to be fixed at the bottom and at the top of the graphic panels (reverse side).

### Hangers

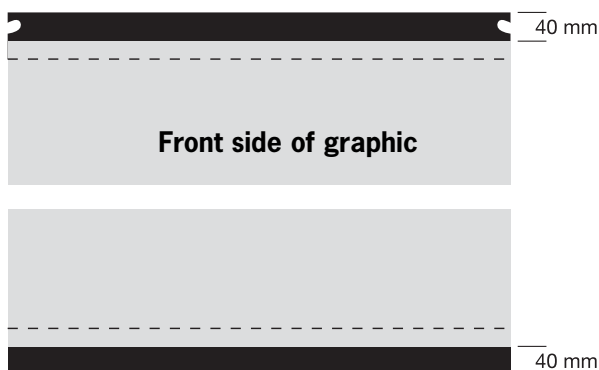

### Kickers

**Please observe!**

Kickers and hangers for the endpanels are thinner.

## Mounting of Magnetic Tape

Magnetic tape to be fixed vertically along each side of the graphic panels.

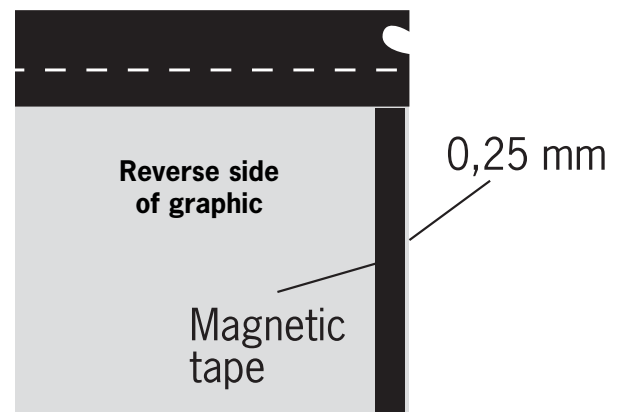

### IMPORTANT

Carefully mount the magnetic tape slightly inset from the edge of the graphic panel by **approximately 0,25 mm**. Once mounted, a very thin straight white line should show between the edge of the graphic and the outside edge of the magnetic tape. **Do not exceed 0,5 mm.**